



CE-VF1000IR

Long Range IR Bullet Camera

- SONY 1/3" CCD (Super HAD)
- 600 TVL Resolution
- 15 Giant IR LEDs (IR LED Adjustment Potentiometer)
- 5 ~ 50mm (F1.2) Lens (Externally Adjustable)
- S5 Digital Signal Processing
- Digital Noise Reduction (DNR)
- Sense Up Feature for Optimal Night Image
- Digital Image Stabilization (DIS)
- High Light Compensation (HLC)
- OSD Menu Control via CE-REMOTE
- Cable Through Bracket Design with Mounting Plate
- Weather Resistant
- DC12V / AC24V

Dimensions

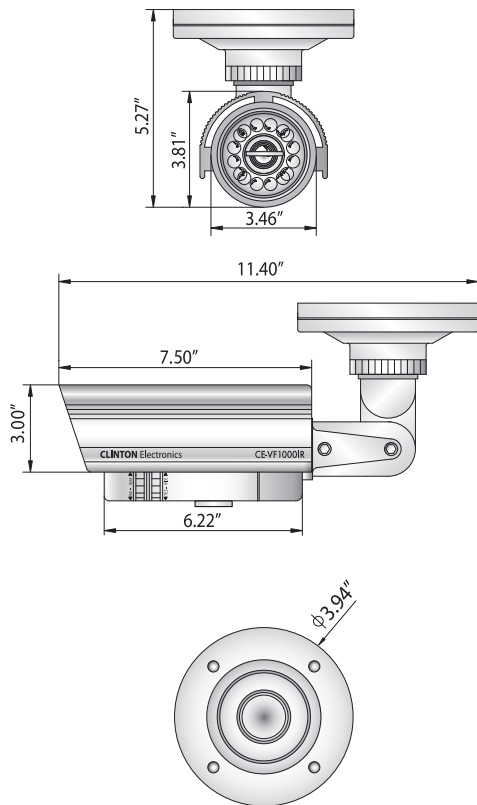

Specifications

| Camera | CE-VF1000IR |
|------------------------------|--|
| Image Sensor | 1/3" CCD (Super HAD) |
| Resolution | 600 TV Lines |
| IR LEDs | 15 pcs of Giant IR LEDs |
| Effective Pixels | 768 (H) x 494 (V) |
| Scanning System | 2:1 Interlace |
| S/N Ratio | More than 50dB |
| Sync System | Internal / Line Lock |
| Scanning Frequency | 15.734 KHz (H), 59.94 Hz (V) |
| Minimum Illumination | IR OFF 0.1 Lux / IR ON 0 Lux |
| Shutter Speed | 1/60 ~ 1/100,000 sec. |
| Lens | 5 ~ 50mm Vari-Focal (Externally Adjustable) |
| Video Output | 1.0 Vp-p, 75Ω |
| Power Consumption | Max. 920mA (DC12V) with IR LEDs ON Max. 500mA (AC24V) with IR LEDs ON |
| Power Requirement | DC12V / AC24V |
| Operating Temperature | -20°F ~ 120°F |
| Operating Humidity | Within 95% RH |
| Dimensions | 11.4" (L) x 3.94" (W) x 5.28" (H) |
| Weight | 4.4 lbs. |
| OSD Menu | Control with CE-REMOTE |
| Lens | DC Video |
| Exposure | Brightness / Shutter / AGC / Sens-Up / Return |
| White Balance Control | ATW / Manual / AWC->SET / Outdoor / Indoor |
| SSDR | Off / On |
| Backlight | Off / BLC / HLC |
| DNR3 | Off / On |
| Day/Night | Auto / Color / B&W / External |
| Special | Image Adj / Monitor / Cam Title / Sync / Motion / Privacy / Comm Adj. / Language / Reset |
| Exit | Save / Not Save / Reset |

Information in this document is subject to change

Recommended Power Supply

| | |
|---------------|------------------------|
| CE-T24VAC800 | 1 Camera 20 watt AC24V |
| CE-T24VAC2000 | 1 Camera 50 watt AC24V |

All Clinton Multi Camera Power Supplies

Optional Accessories

- CE-REMOTE
- Plugs directly into Camera
 - Adjusts OSD Functions
 - Test Monitor Connection

