



CE-VFCD955-WD

Indoor Wide Dynamic Dome Camera

- PIXIM 1/3" C-MOS
- 540 TVL Resolution
- 2.9 ~ 10mm (F1.2) Lens
- Digital Pixel System® (DPS)
- 120dB Maximum Wide Dynamic Range
- Application Presets (Normal, Indoor, Outdoor, Custom)
- OSD Menu Control via Built-in Button Pad
- 3-Axis Adjustment
- DC12V / AC24V

Dimensions

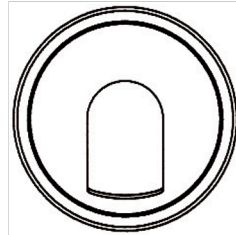
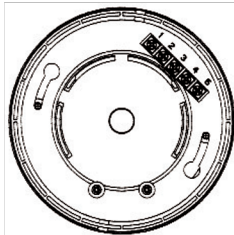
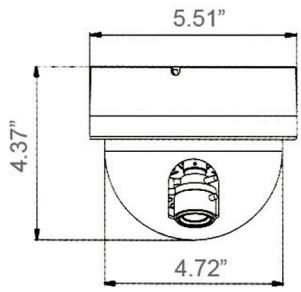

Specifications

Camera	CE-VFCD955-WD
Image Sensor	1/3 Inch PIXIM C-MOS
Resolution	540 TV Lines (High Resolution Mode)
Effective Pixels	720 (H) x 540 (V)
Scanning System	525 Lines, Interlace
S/N Ratio	More than 48dB (AGC Off)
Sync System	Internal (DC12V) / Line Lock (AC24V)
Scanning Frequency	15.734 KHz (H), 59.94 Hz (V)
Minimum Illumination	0.1 Lux (Slow Shutter Mode)
Shutter Speed	1/60 ~ 1/100,000 sec.
Dynamic Range	120dB (Max.), 101dB (Typical)
Lens	2.9 ~ 10mm (F1.2) Lens
Video Output	1.0 ~ 1.2Vp-p, 75Ω
Power Consumption	Max. 160mA (AC24V), Max. 320mA (DC12V)
Power Requirement	DC12V / AC24V
Operating Temperature	32°F ~ 113°F
Operating Humidity	Within 90% RH
Dimensions	5.51" (Dia.) x 4.37" (H)
Weight	1.26 lbs.
OSD Menu	Control with OSD Button Pad
Presets	Normal / Indoor / Outdoor / Custom
Lens	DC (Set BIAS and Limit)
White Balance Control	ATW / AWC Des / Manual
Gain Control	Off / Low / Middle / High
Special	Camera ID, Mirror, Backlight (BL Zone1), Resolution, Advanced (video Standard, Sync, Sharpness, Aperture), Save / Restore

Information in this document is subject to change

Recommended Power Supply
All Clinton Electronics Power Supplies

