

CE-CPEX(B) Install Guide

Included Items:

- Extension Pole
- Mounting Hardware
- Instructions

Required Items:

- 7/16" Wrench
- 10mm Wrench
- Phillips Head Screwdriver



Maximum Load Capacity: 10 lbs / 4.5 kgs



CAUTION!

USE ONLY AS DESIGNED

This product is designed to serve as an extension between an existing Telescoping Camera Pole mount and the camera. Refer to the camera pole installation guide for details on installing the camera pole. Combined weight of extension pole(s) and equipment not to exceed 10lbs/4.5kgs weight limit of Telescoping Camera Pole. It is intended for use only with the maximum weight indicated. Use with products heavier than the maximum weights indicated may result in instability causing possible injury.

1. FEED CABLES THROUGH POLE

Feed the desired power and video cables through the wider top end of the extension pole and down through the bottom of the pole.

2. ATTACH EXTENSION TO CAMERA POLE

Slide extension pole over the end of the camera pole and insert the bolt and washer into the top hole to join the poles together. Attach the washer, lock washer, and locknut to the bolt. Tighten with a 10mm and 7/16" wrench.

3. CONNECT CONDUIT ADAPTER AND CABLES

Thread the conduit adapter originally supplied with the camera pole onto your camera's pendant cap, and connect power and video cables to your camera.

4. SECURE CAMERA

Slide the conduit adapter onto the end of the extension pole, and tighten the Phillips head screw against the surface of the pole. The Phillips head screw should not thread into the side hole in the pole.

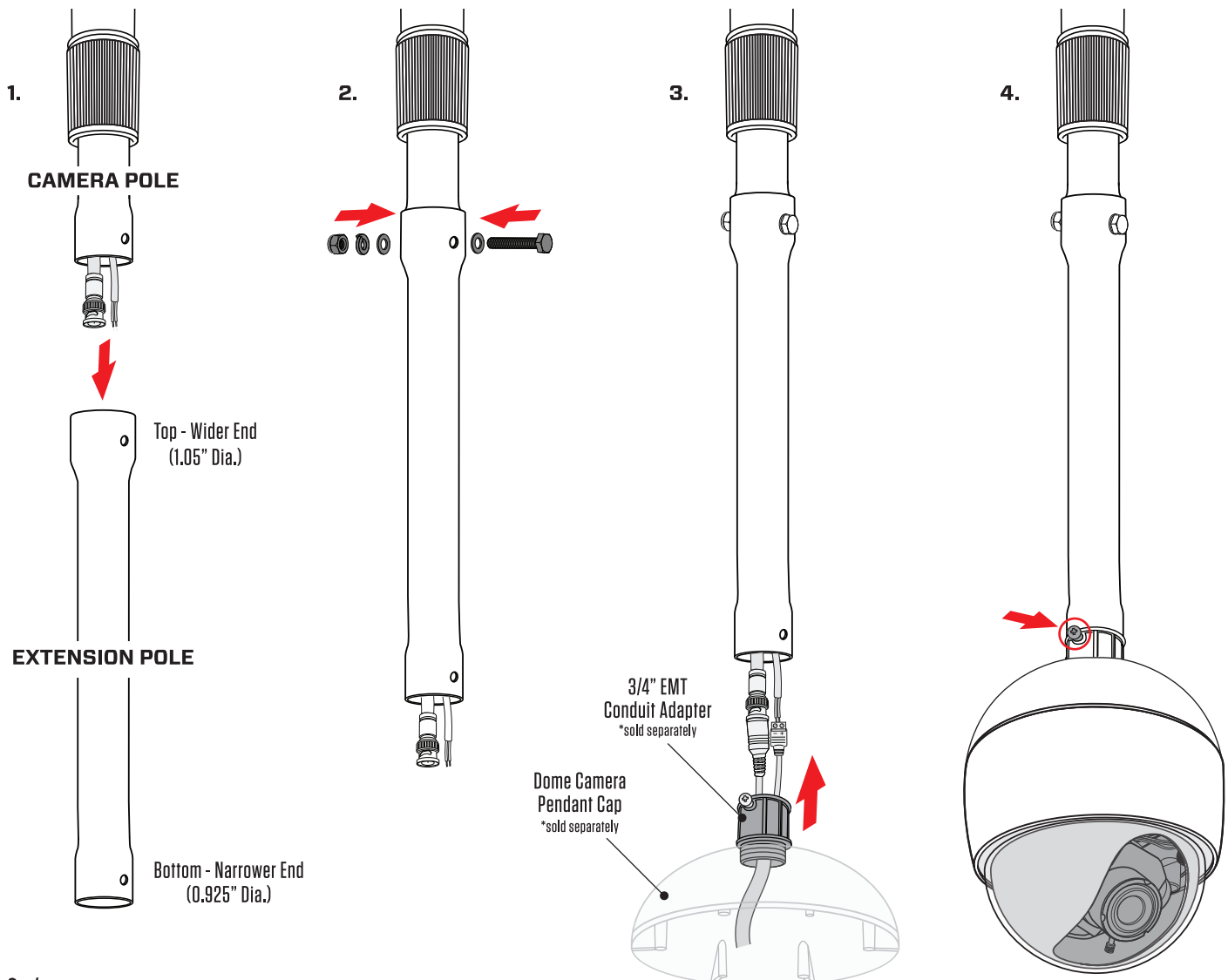

*Not to Scale