

Telescoping Camera Pole Pre-Assembly Instructions

The mounting head of the Telescoping Camera Pole has been removed for shipping and needs to be installed if securing to ceiling truss structure. If camera pole is to be used with Clinton Electronics Ceiling Tile Mount Kit or Swivel Mount the mounting head can be discarded.

1. Insert 3/8"-16 Bolt

Guide the bolt through the bottom of the mounting head, and if desired loosely attach the fender washer and 3/8"-16 lock nut (not shown) to retain bolt to the head.

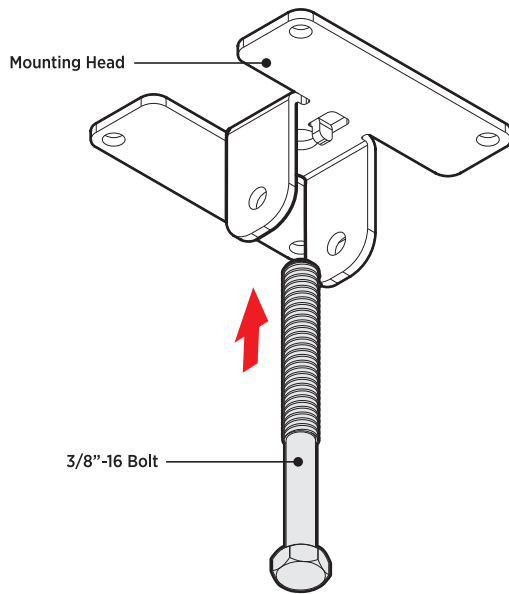

2. Attach Head

Guide the head onto the larger diameter/top of the camera pole. Align holes in mounting head to holes on camera pole. Place one eyelet-end of the safety cable and washer onto the 1/4"-20 Allen-head bolt. Guide the bolt through the mounting head and camera pole.

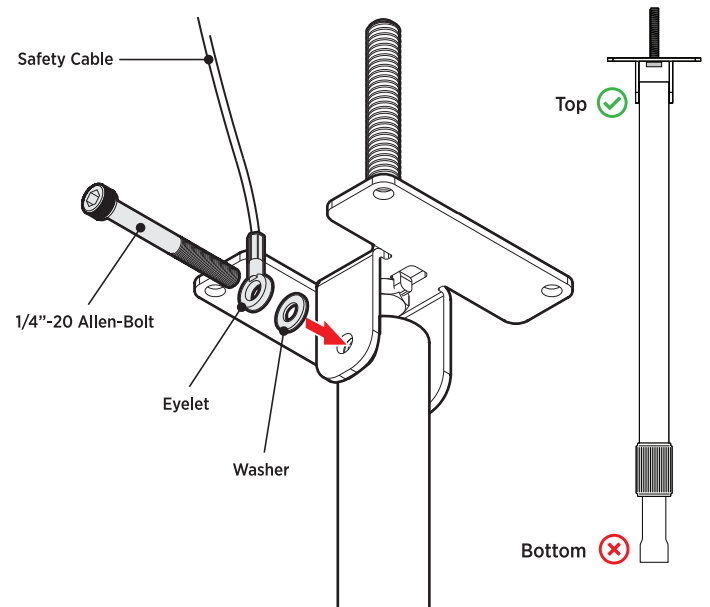

Do not install onto the smaller diameter, flared end of the camera pole, this is the bottom of the pole.

3. Secure 1/4"-20 Bolt

Place 1/4" washer, lock-washer and lock nut onto end of bolt. Tighten lock-nut with 7/16" wrench and 3/16" Allen wrench.

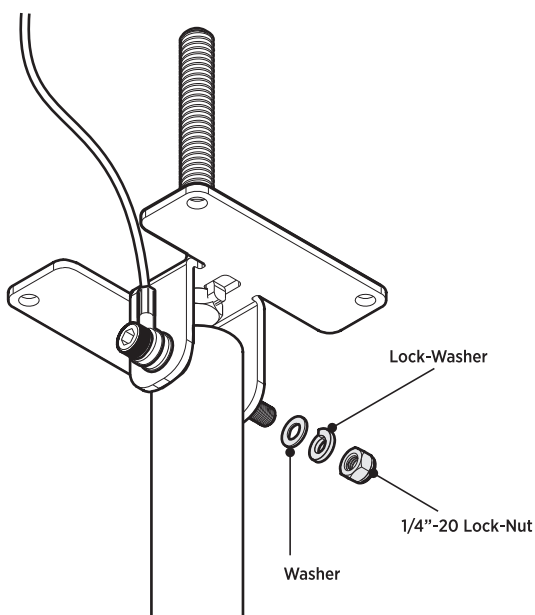

CONTINUE
TO STEP 2 of
Install Guide:
"Secure to Truss
or Channel Strut"

Telescoping Camera Pole Install Guide

For Telescoping Camera Pole Models:
CE-CP3W, CE-CP6W, CE-CP12W, CE-CP17W
CE-CP3B, CE-CP6B, CE-CP12B, CE-CP17B

Included Items:

- Telescoping Pole
- Mounting Hardware
- Rivet(s)
- Safety Cable
- 3/4" EMT Conduit Connector

Required Items:

- Phillips Head Screwdriver
- Drill with 3/16" Drill Bit
- 7/16" Wrench
- 9/16" Wrench
- 3/16" Allen Wrench
- Hammer



Maximum Load Capacity: 10 lbs/4.5 kgs



ATTENTION!

USE ONLY AS DESIGNED

This mount is designed to mount a camera from the ceiling steel support truss or channel strut structure. It is not designed to mount to a wooden surface. It is intended for use only with the maximum weight indicated. Use with products heavier than the maximum weights indicated may result in instability causing possible injury.

1. Remove Hardware

1.A Using a 9/16" wrench, remove the 3/8"-16 Lock Nut and Fender Washer from the mounting bolt.

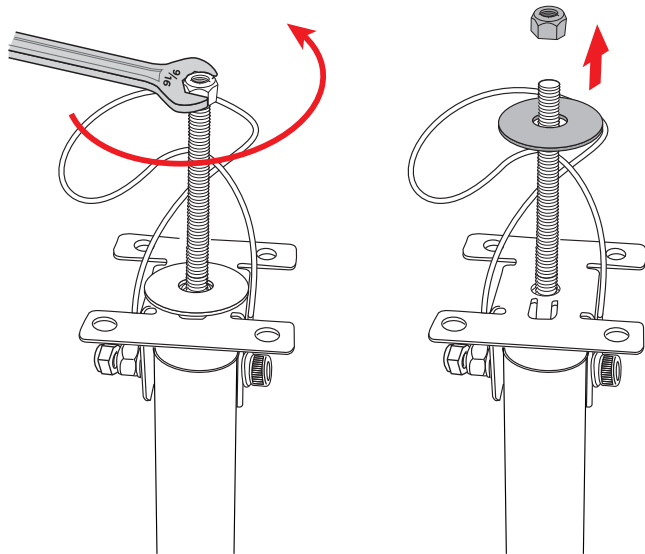

1.B Using a 7/16" wrench and 3/16" Allen wrench, remove the 1/4"-20 Safety Cable Lock Nut and separate cable from bolt.

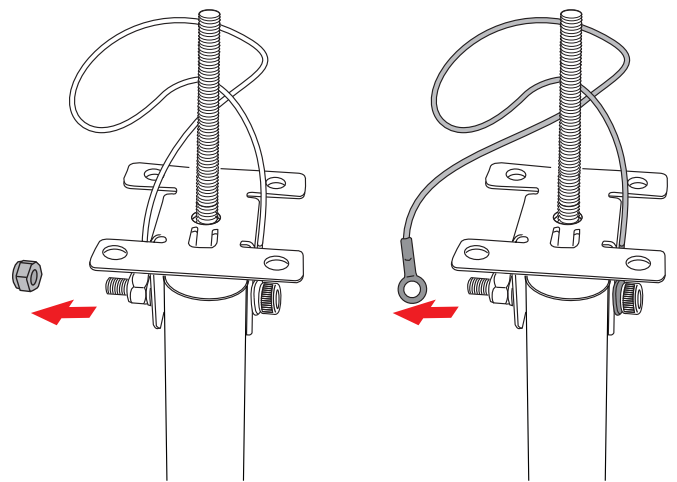

2. Secure to Truss or Channel Strut

2.A Insert mounting bolt from camera pole between the gap in the truss or channel strut. If no gap is available drill a hole into steel mounting surface.

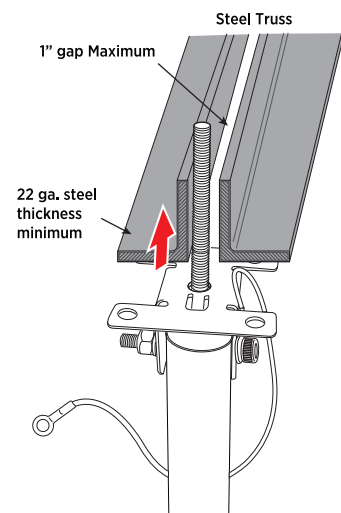

IF DRILLING IS NECESSARY, USE 7/16" METAL DRILL BIT TO DRILL THROUGH STEEL MOUNTING SURFACE.

Minimum Hole Size: 3/8"
Maximum Hole Size: 5/8"



2.B Place the Fender Washer and 3/8"-16 Lock Nut onto the mounting bolt. Tighten the 3/8"-16 Lock Nut with a 9/16" wrench.

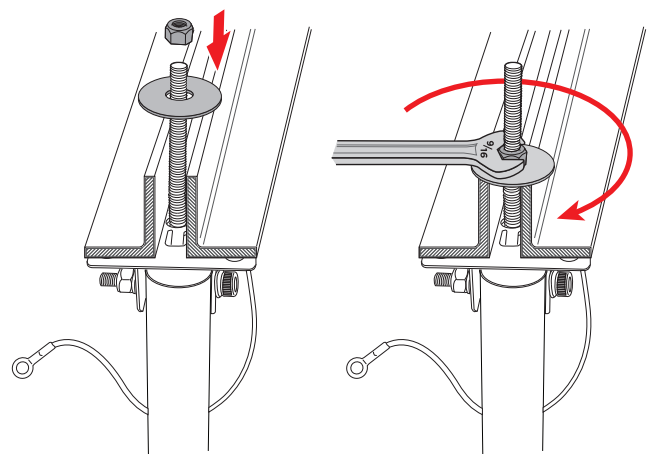

3. Attach Safety Cable

Loop the Safety Cable around the steel truss or channel strut. Place the end of the Safety Cable and 1/4"-20 Safety Cable Lock Nut onto the Allen head bolt. Tighten Lock Nut with 7/16" wrench and 3/16" Allen wrench.

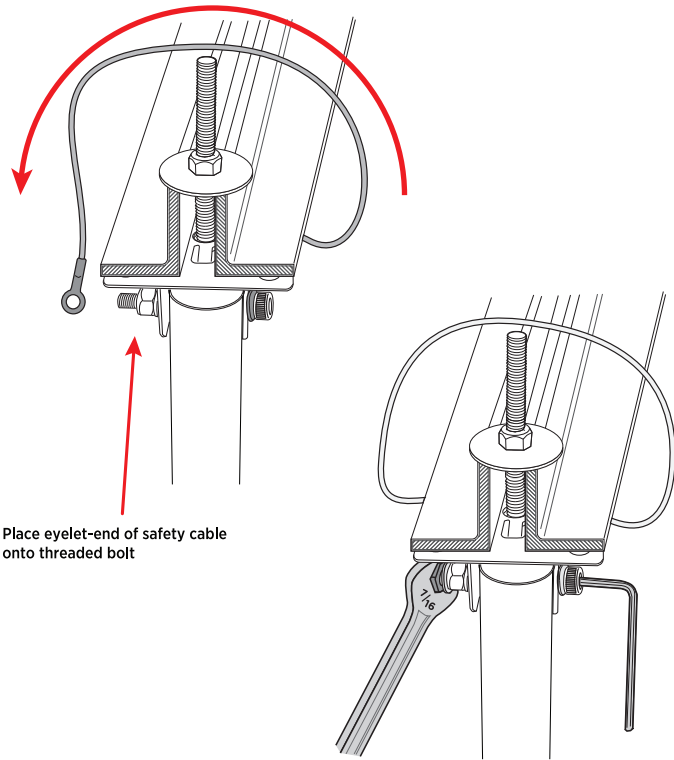

4. Adjust Height

While supporting the pole by the bottom end, loosen the twist-lock collar by turning it counter-clockwise. Extend the pole by gently lowering it to the desired height.

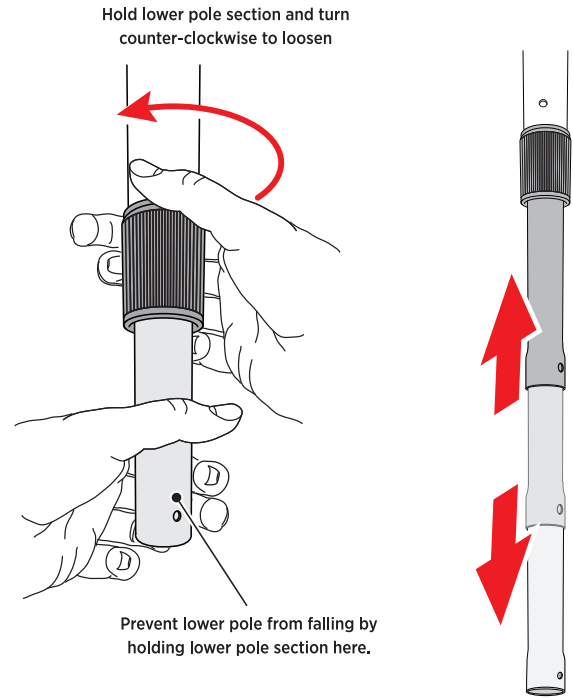

Once the height of the pole has been adjusted, lock the pole in position by rotating the twist-lock collar clockwise. The collar should be hand tightened as snug as possible to prevent the pole from extending (dropping down).

5. Install Rivet

After the pole is set to its desired length, drill a 3/16" hole through one side of the inner pole at the pre-drilled hole in the outer pole. Insert the rivet until the backside of the head is flush with the outer surface of the pole. While supporting the backside of the pole, strike the pin sharply with a hammer to expand the rivet.

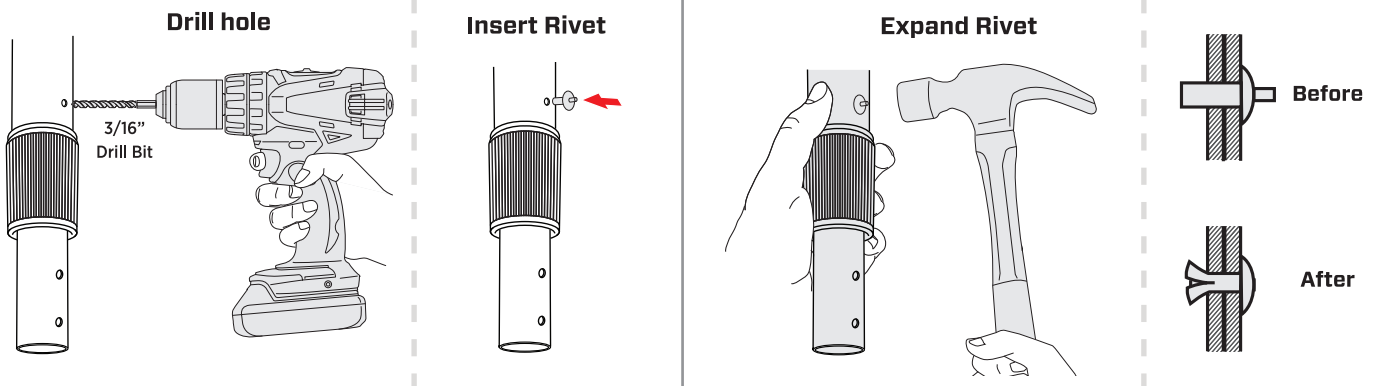

***CE-CP17 (17 ft pole) only:** This pole requires two rivets to be inserted, one for each section of telescoping pole length, (one above each locking collar). Repeat the steps above for each section of pole.

THE DRIVE RIVET IS REQUIRED TO MEET UL SAFETY REQUIREMENTS AND MUST BE INSTALLED.

6. Conceal Cables

Feed necessary cables through the top of the pole and out through the bottom. If BNC connector is already installed onto coax cable from head unit, it may be required to temporarily remove the bolt that attaches the mounting head to the camera pole.

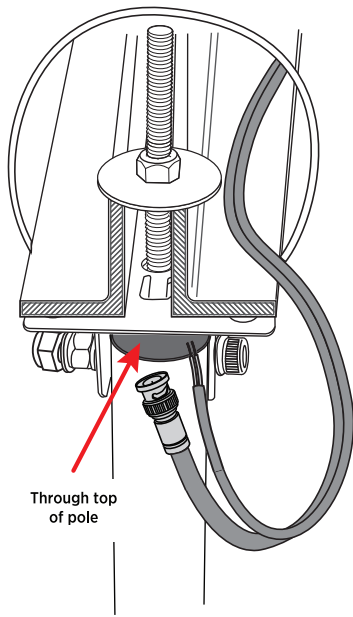

Through top of pole

Feed cables/wires through bottom of pole

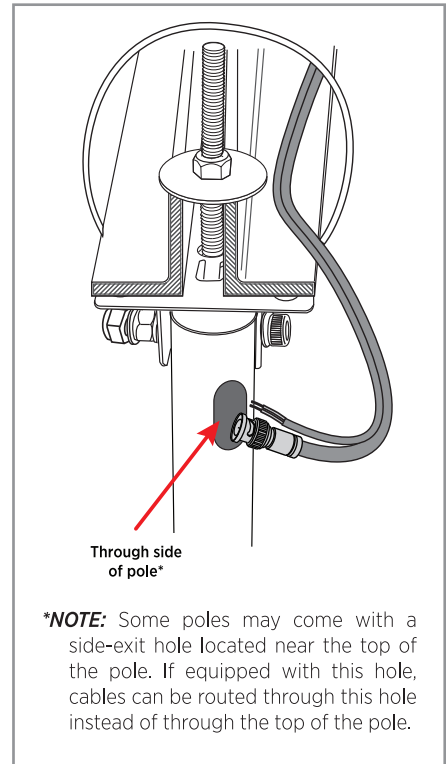
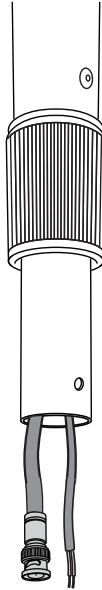

Through side of pole*

***NOTE:** Some poles may come with a side-exit hole located near the top of the pole. If equipped with this hole, cables can be routed through this hole instead of through the top of the pole.



USE ONLY SELV WIRING

Use only SELV (Separated/Safety Extra-Low Voltage) power supply wiring. Max voltage not to exceed safe value of 60VDC or 42.4VAC.

7. Mount Camera to Pole

7.A Connect the appropriate pendant mount cap (with 3/4" EMT conduit set-screw connector) to the dome camera according to the pendant mount instructions.

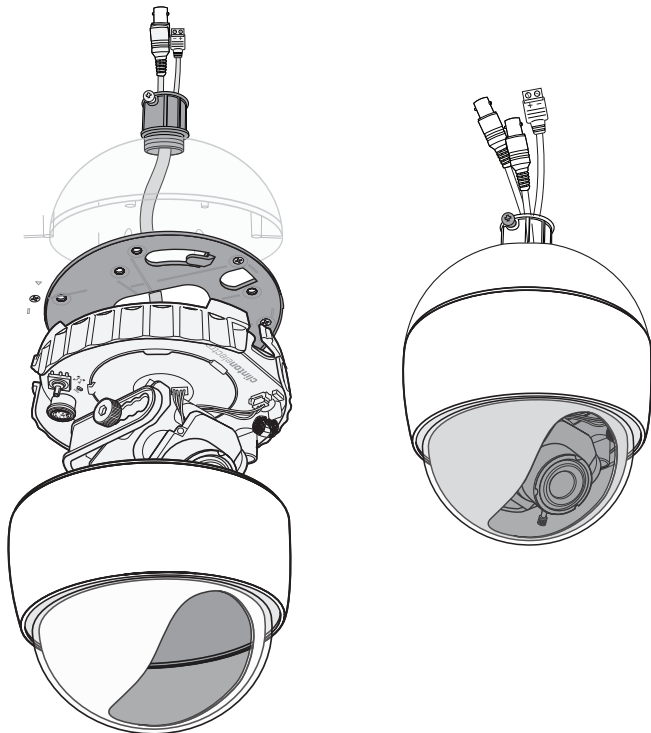

7.B Make power and video connections to the camera, and connect the pendant mounted camera assembly onto the extension pole. Slide the 3/4" EMT conduit connector over the end of the extension pole. Tighten the set-screw on the conduit connector so it presses onto the side of the pole.

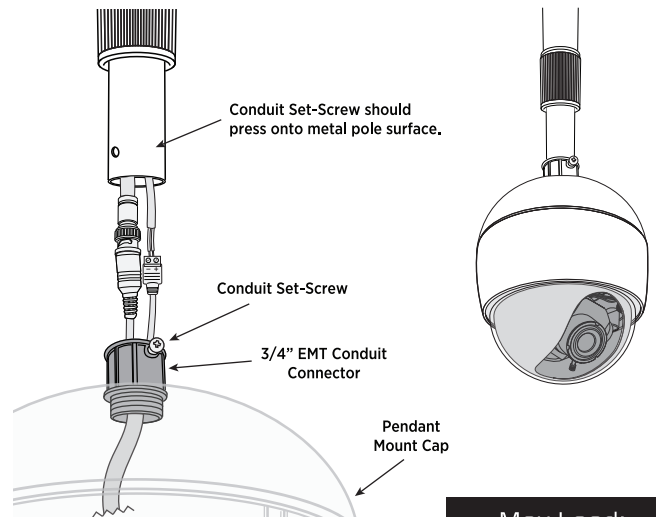

**Max Load:
10 lbs / 4.5 kgs**



This mount is intended for use only with the maximum weights indicated. Use with products heavier than the maximum weights indicated may result in instability causing possible injury. This product is intended to mount to a steel support truss, or channel strut.

*Camera pendant mount shown not included, sold separately.