

CE-T10QHD Install Guide

Included Items:

- 4MP Turret Camera x 1
- Phillips Screws x 3
- Drywall Anchors x 3
- 1.5mm Allen Wrench x 1

Required Items:

- 12VDC or 24VAC Power Supply (Sold Separately)
- Phillips Head Screwdriver

Optional Items:

- Power Drill with 3/4" Drill Bit
- Test Monitor

1. PREPARE MOUNTING SURFACE

Depending on the installation type; cable routed through the surface or cable routed on surface exterior- a hole may be required. If the cable will be routed through the surface, a 3/4" hole is required to fit the cable, connections & joystick through the surface.

Cable Routed Through Surface

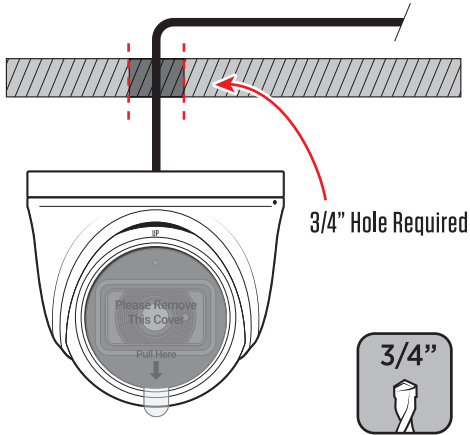

Cable Routed On Surface

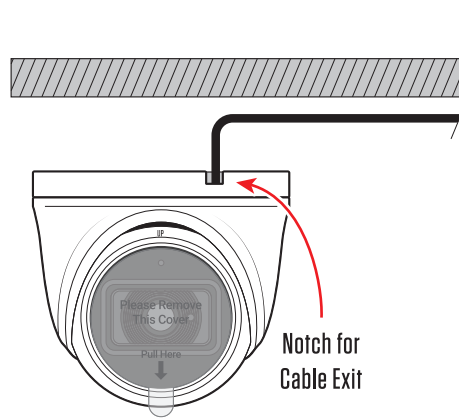

3. INSTALL MOUNTING BASE

Hold the mounting base onto the surface and attach using the (3) supplied Phillips-head screws. **NOTE: It is recommended to use the drywall anchors if mounting to drywall.*

If Cable Routed On Surface:
Connect cables first, then
install mounting base

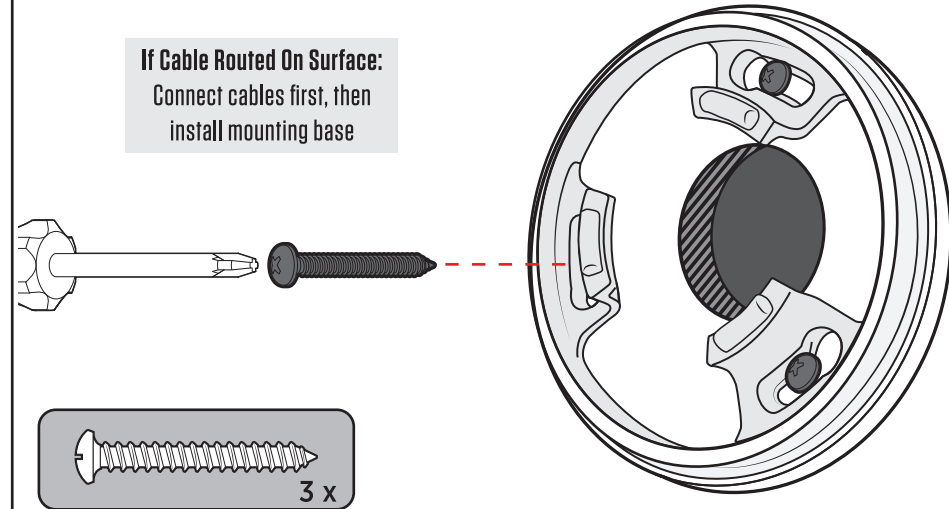

2. SEPARATE CAMERA FROM MOUNTING BASE

Loosen the Allen set screw on the base of the camera with the included 1.5mm Allen wrench, (do not remove the set screw) then separate the IR camera ball and shroud from the mounting plate.

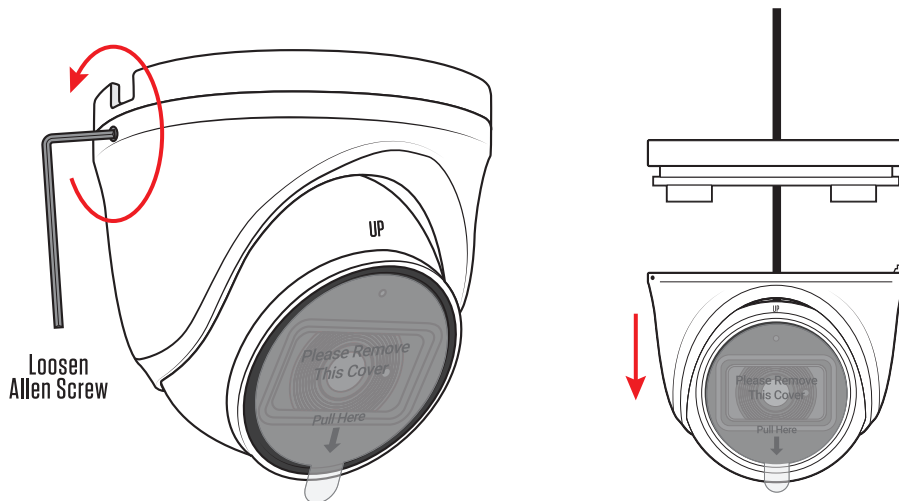

4. CONNECT CABLES

Make connections to the power and BNC cable (BLACK connector is for EX-SDI, GREEN connector is for Analog video). To ensure quality operation, verify proper BNC and power termination, along with proper voltage at camera.

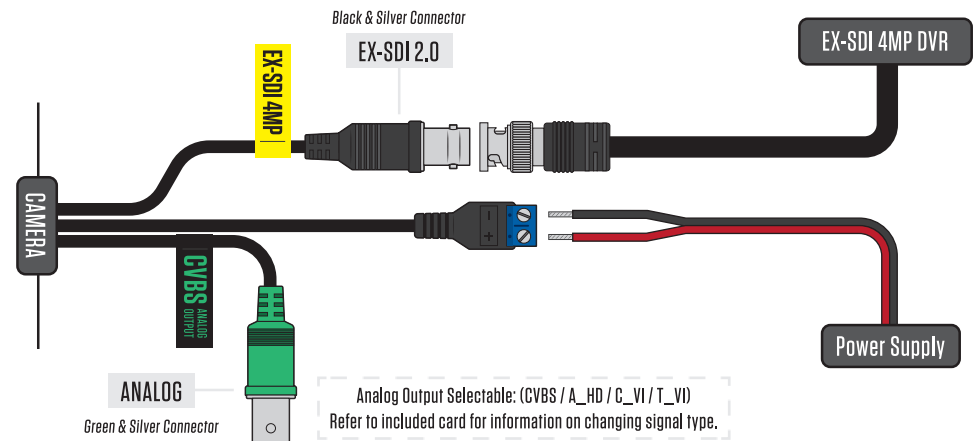

5. REMOVE PROTECTIVE FILM

Remove the protective film over the face of the camera. An out-of-focus, discolored, and poor night-time image can result if this film is not removed.



7. ATTACH CAMERA TO MOUNTING SURFACE

While holding the IR camera ball and shroud, hook the tab on the shroud (located opposite the set screw) onto the mounting base. Loosely tighten the set screw with the included 1.5mm Allen wrench to hold the IR camera ball and shroud onto the mounting base. While loose, make camera angle adjustments by rotating the camera ball as necessary.

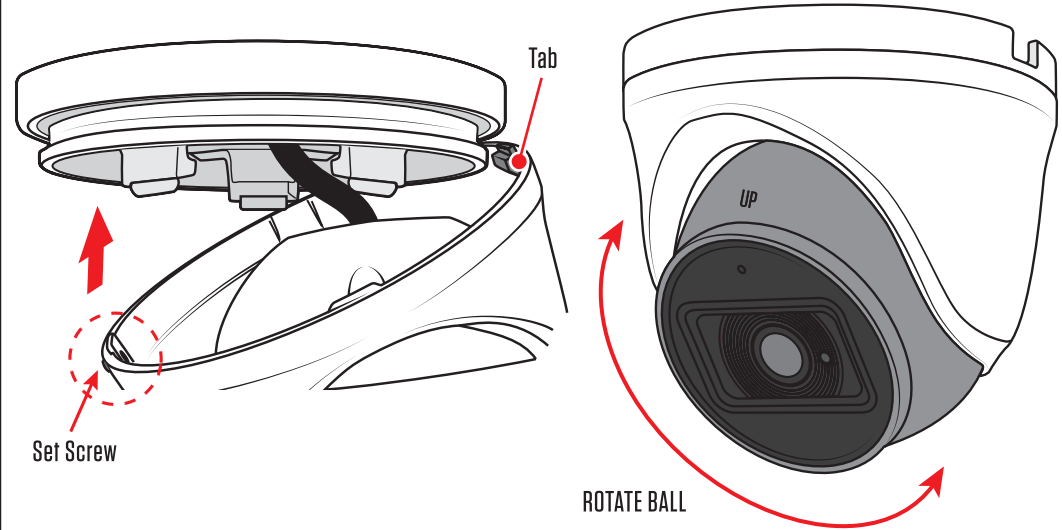

6. CHECK CAMERA ANGLE / ADJUST CAMERA SETTINGS

Before proceeding with final assembly it is suggested to test the camera with a test monitor to verify approximate camera angle. To test; plug an analog test monitor into the Analog BNC (GREEN) connection from the camera. OSD (On Screen Display) adjustments can be made by using the Joystick on the cable.

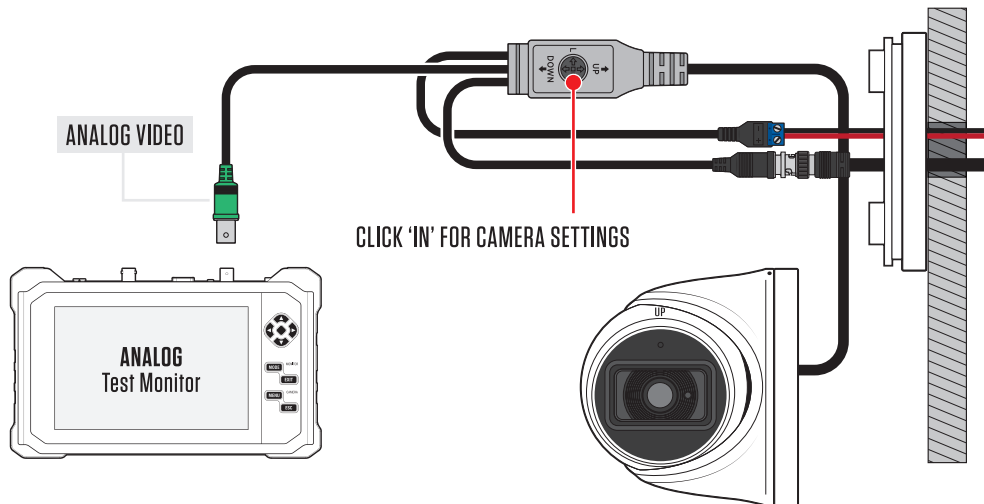

**visit ClintonElectronics.com for OSD Manual*

8. FINAL ADJUSTMENT & TIGHTEN COLLAR

Adjust the camera angle as needed, then firmly tighten the set screw to lock the camera angle in position. Ensure the word 'UP' is oriented to the top of the camera. If the word 'UP' is in different position the image may be upside-down or rotated.

