

## ITEMS INCLUDED

- DC 24V 1.5A Power Supply Unit
- AC Power Cable
- Instructions
- Female Pigtail Splice Cable
- Power Supply Mounting Bracket

## TOOLS REQUIRED

- Wire Cutters / Crimpers
- Mounting Screws
- \*Screwdriver, or Power Drill with \*Bit  
(\*type depends on your chosen mounting hardware)



TO REDUCE THE RISK OF ELECTRIC SHOCK,  
DO NOT DISASSEMBLE  
NO USER SERVICEABLE PARTS INSIDE.  
REFER SERVICING TO QUALIFIED SERVICE PERSONNEL.

1. Before any installation or maintenance work, please disconnect your system from the utility. Ensure that it can't be reconnected inadvertently!
2. Installation and service should be done by qualified personnel only. All work should conform to local codes.
3. Using replacement parts and/or accessories not approved of by Clinton Electronics may void warranty.
4. Mount the unit in an area that cannot be easily accessed by non-qualified personnel.

5. Do not install power supplies in places with high moisture or near water.
6. Do not install power supplies in places with high ambient temperature or near fire source.
7. Do not "daisy chain" power runs to monitors. All power runs from each display must go directly to the Power Supply.

Wire Guideline:  
In most cases the CE-PS24 can safely power LCDs or PVMs up to 25 Watts. For best results, use only high-quality 18 or 16 gauge wire.

## 1. CONFIRM POWER REQUIREMENTS

If the monitor or PVM you are powering is a 24 volt DC monitor and draws less than 25 watts (1.5 amps), the CE-PS24 can power it. If you are unsure, call Clinton Technical Support at 1-800-549-6393.

## 2. NO-SPLICE POWER

If the device you are powering is located within 8 feet of the wall outlet, simply plug the AC cord into the wall outlet. There is no need for splicing on the pigtail connector or additional 2-conductor wire.

## 3. SPlicing GUIDELINES

If the device is to be mounted further than the combined length which the AC and DC power cords can reach (8'), then you can run 2-conductor wire and splice the included female pigtail onto your wire and connect to the DC output from the power supply. Use the following guidelines for determining maximum wire runs.

| For powering a 0.8A device |                                     |
|----------------------------|-------------------------------------|
| Wire Gauge                 | Max. Wire Length (20% voltage drop) |
| 18 AWG                     | 400 feet                            |
| 16 AWG                     | 700 feet                            |

## 4. MOUNT POWER SUPPLY

Place the power supply within cable range of your chosen wall outlet. If desired, slide the included mounting bracket over the power supply and attach it to your mounting surface using 4 fasteners (not included).

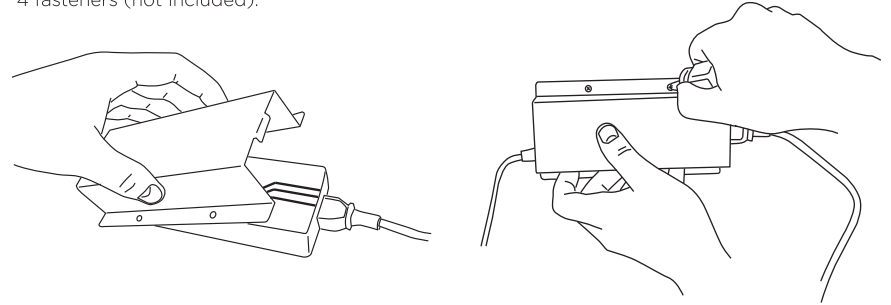

## 5. SPLICE CABLE

After determining the correct length and wire gauge needed, butt splice your wire to the pigtails using a wire crimping tool. NOTE - A male pigtail is not included with the CE-PS24 power supply, however it may be included with your monitor.

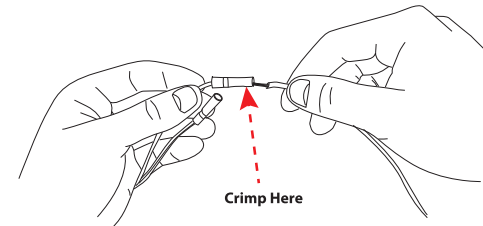

## 6. MAKE POWER CONNECTIONS

Plug the included female pigtail onto the power supply's male barrel plug end.

Plug the male pigtail (not included) into the 24VDC power input located on the back of your monitor or PVM.

Plug the AC power cord into the wall outlet, and turn on your monitor.

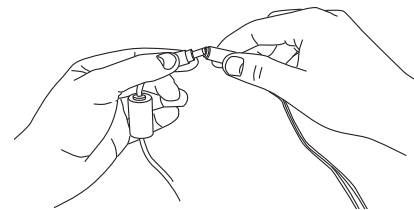

FEMALE PIGTAIL - INCLUDED WITH CE-PS24

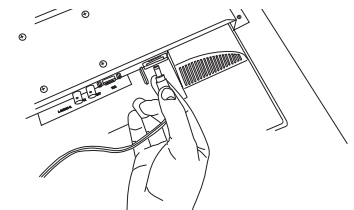

MALE PIGTAIL - NOT INCLUDED WITH CE-PS24 (MAY BE INCLUDED WITH MONITOR)