

VX Core Series Install Guide

For 2MP & 5MP Network Vandal X Outdoor Dome Cameras

Included Items:

- VX Outdoor Dome Camera x 1
- Torx Wrench (T20 Security) x 1
- RJ45 Weather Resistant Cover x 1
- Phillips Head Screws x 4
- Drywall Anchors x 4
- Instructions x 1
- Mounting Template x 1

Required Items:

- Phillips Head Screwdriver
- Drill with 1/4" or 5/8" Drill Bit

- PoE Power Supply

Optional Items:

- microSD Card (not included)

Installation should be performed by qualified service personnel only and should conform to all applicable local codes.

OVERVIEW

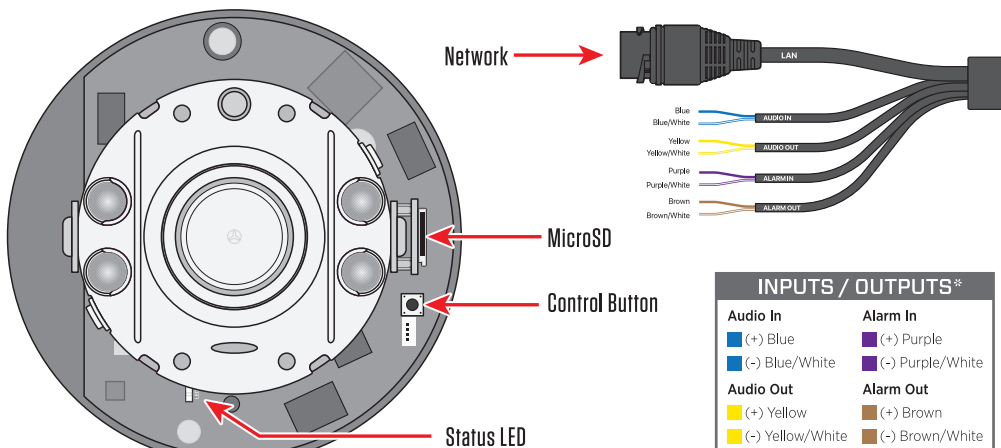

*Connections may vary by model.

⚠ LOGIN INFO

This camera does not have a default password. You must create a password to set up and view the camera. The username is **ADMIN**.

⚠ IP ADDRESS

This camera is set to use DHCP. If no DHCP network is available, you can connect to the camera with the default IP Address: **192.168.1.90**

i CAMERA DISCOVERY

Scan the QR Code to the right to download **Clinton IP Finder**.



Available for
Windows or MacOS.



Clinton IP Finder

i REBOOT / RESET

REBOOT: Press and hold the **CONTROL BUTTON** for 5 seconds, then release.

FACTORY DEFAULT: Press and hold the **CONTROL BUTTON** for 15 seconds, then release.

? SUPPORT

Need Help? Scan the QR Code or go to www.support.clintonelectronics.com to search our Knowledge Base, find firmware updates, or download software.

Clinton Support



BATTERY WARNING: Do not expose the battery to extremely high temperatures and/or extremely low air pressure, this can result in an explosion or the leakage of flammable liquid or gas from the battery.

1. REMOVE DOME COVER

(a) Loosen the three Torx screws using the included T20 Security Torx wrench, then remove the dome cover from the camera base. Leave the protective film on the dome bubble until the final step.

(b) Remove the four Phillips head screws that hold the inner case onto the camera base, then remove the inner camera assembly from the camera base. Keep these 4 screws for final assembly.

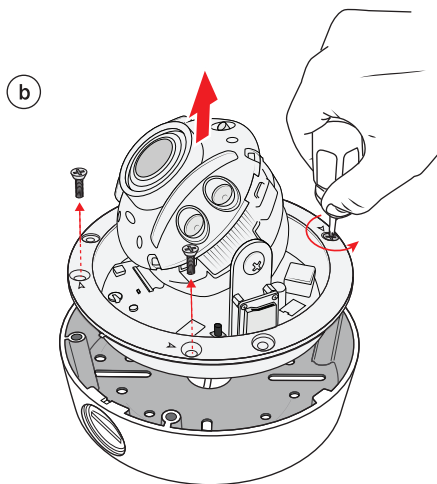
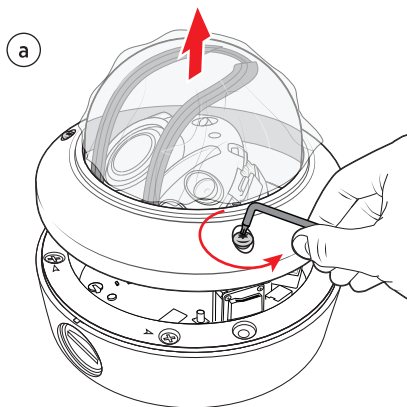

i NOTICE *The 3 Torx screws are not designed to be removed from the dome top.*

2. MOUNT OUTER CASE

If mounting to solid surface, use the four Phillips head mounting screws & drywall anchors if necessary. Mark and drill a 13/16" (20mm) hole if the cable will be passed through the mounting surface.

If mounting to a conduit box, choose the mounting hole pattern that best suits your application and use the appropriate screws. Multiple mounting hole patterns are provided.

3/4" EMT conduit can also be attached to the outer case using a threaded 3/4" EMT conduit adapter (not included). Connect either to the hole in the bottom/center of the case or the hole on the side.

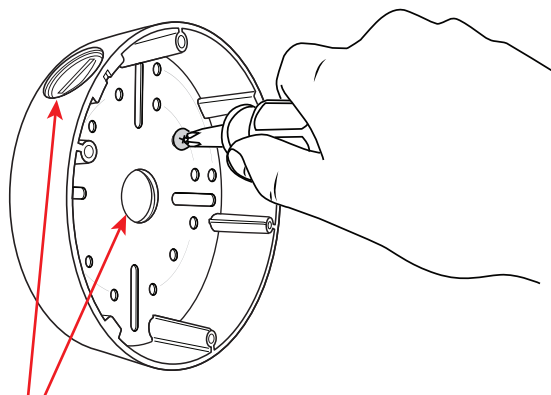

3/4" EMT Threads

HOLE SIZE IF PASSING CABLE
THROUGH MOUNTING SURFACE

13/16" (20mm)



3. CONNECT NETWORK CABLE

Connect a network cable to the camera. Ensure the network cable length is less than 300ft, longer cable runs will cause data and power issues. The camera will automatically power ON when connected to a PoE switch or injector. Ensure the PoE source has enough available power budget for powering the camera.

If the network cable will be exposed to weather/moisture, it is strongly suggested to use the included weather resistant cover. *Refer to separate "Cable Weatherproofing Guide."

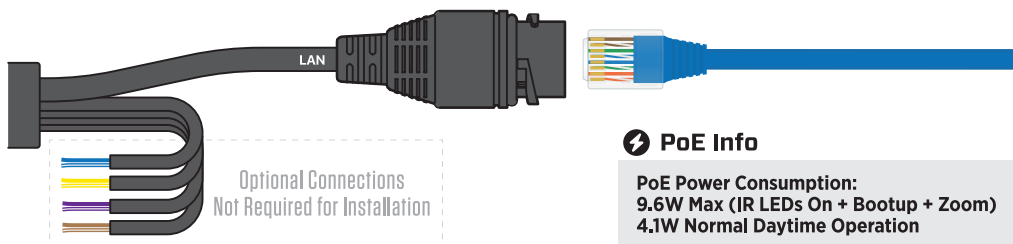

4. ATTACH CAMERA

(a) Align the key on the lip of the inner camera assembly with the slot on the camera base when reassembling. If these are not aligned properly the weather resistant seal will be compromised, allowing water to leak into the camera.

(b) Replace the four Phillips head screws that hold the inner case to the camera base. The four holes are marked with arrowheads.

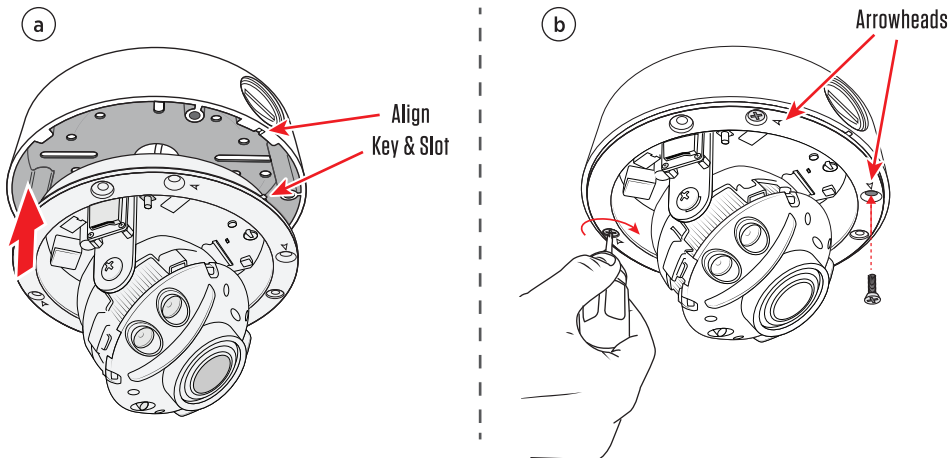

5. ADJUST CAMERA

Adjust the angle of the camera as necessary. Avoid touching the lens when adjusting the camera.

- **A. Camera Tilt:** Angle the camera up or down. Check the tightness of the screws to ensure the tilt does not change.
- **B. Camera Pan:** Turn the camera assembly left or right. There is a “stop” that prevents the camera from rotating more than 180° in either direction.
- **C. Lens Rotation:** Rotate the lens as needed to adjust the level. To rotate, move the notched inner-assembly left of right. Rotate 90° for hallway applications (also requires Corridor Mode to be enabled in camera settings to rotate network video).

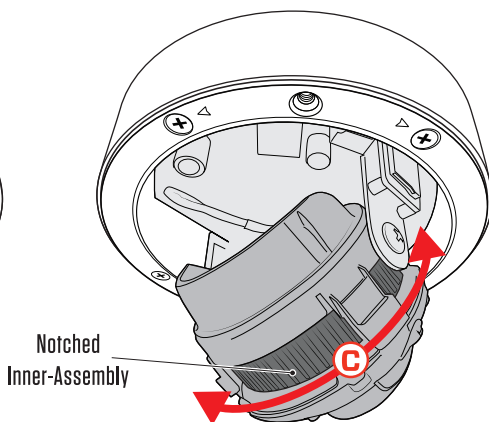
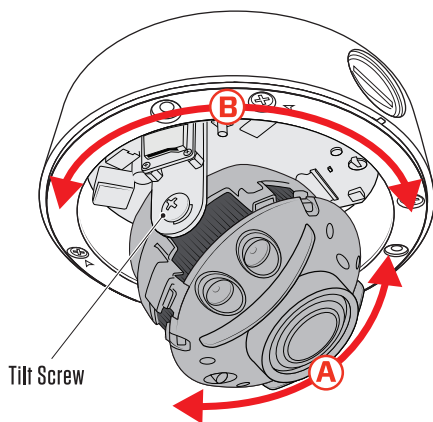

6. ATTACH DOME COVER

(a) Replace the dome cover onto the camera base. Align the IR Shield tracks with the guides on the camera assembly by turning the dome bubble. The cover must be loose, with no pressure applied, to turn the bubble. (It may be easier to turn the bubble with the cover removed).

(b) Using the supplied Torx wrench, tighten the 3 Torx screws that hold the dome cover onto the base. Make sure each screw is tight to ensure superior weather resistance. Remove the clear protective film when finished.

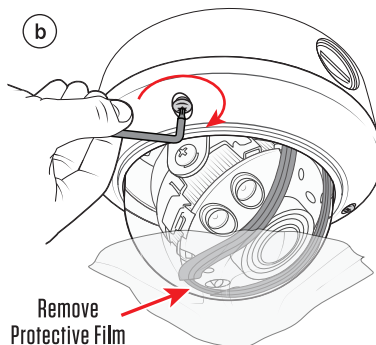
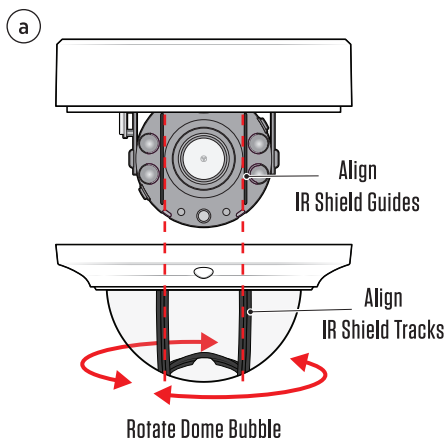

! ATTENTION:
FULLY TIGHTEN TORX SCREWS
If torx screws aren't fully tightened the weather resistant seal will be compromised, allowing water to leak into the camera.

CABLE WEATHERPROOFING GUIDE

If the ethernet cable will be exposed to weather/moisture, it is strongly suggested to use the included weather resistant cover (connection covers, gasket and gasket cover).

1. Attach the O-Ring to the RJ45 Connector from the camera.
2. Feed the rear cover, split gasket, and front cover around the ethernet cable.
3. Twist and lock the front cover onto the RJ45 connector and O-ring.
4. Firmly seat the split gasket into the rear of the front cover, then tighten the rear cover onto the front cover.

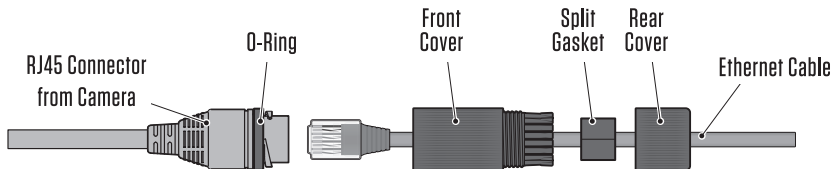

Optional: For added weather protection, wrap the weather resistant cover and RJ45 connector with weatherproof butyl tape. *Tape not included.

Wrap with tape

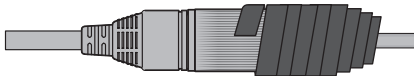

Fully taped

