

CE-CTSMD

Ceiling Tile Surface Mount Dome Housing



GENERAL	
Materials	Polycarbonate & ABS
Dimensions (Dia. x H) *including flange bolt	7.28" x 10.31" / 185mm x 261.87mm
Dimensions (Dia. x H) *installed on surface, viewable	7.28" x 6.43" / 185mm x 163.32mm
Weight	1.0 lbs / 0.45 kgs

DIMENSIONS:

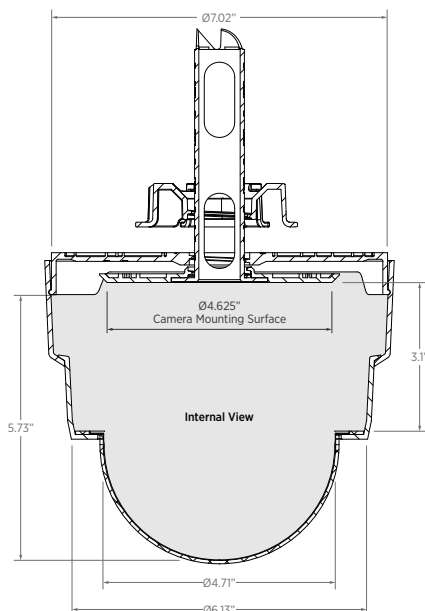
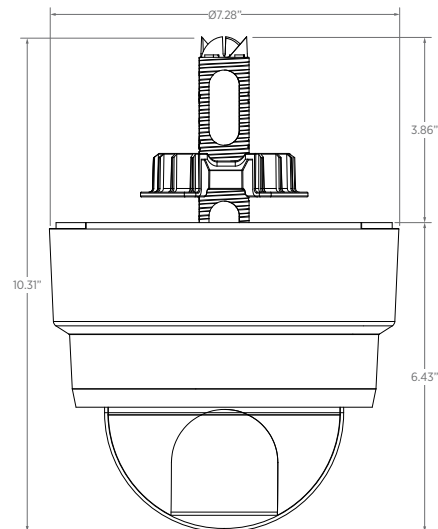

KEY FEATURES:

- Clean, professional dome housing surface-mounted security cameras
- Universal design supports camera housings up to 6" in diameter
- Mounts to ceiling tiles or other surfaces up to 1.5" thick
- Supports a wide range of camera types, including micro domes, vandal domes, fisheye, and turret cameras
- Cameras attach directly to the mounting plate using self-drilling screws
- Adjustable camera height via repositionable mounting plate
- Secures to ceiling using a hollow flange bolt and locking nut
- Includes two camera masks: cutout mask for use with installed cameras & full mask for dummy dome applications
- Easy dome installation with snap-fit design
- Lightweight, durable polycarbonate & ABS construction

MASK OPTIONS:

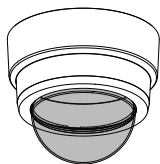

No Mask
IR & 360° Cameras



Cutout Mask
Non-IR Cameras

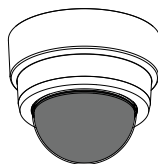

Full Mask
Dummy Dome