

CE-VXRM Install Guide

Included Items:

- Vandal X Recess Mount x 1
- Instructions x 1

Required Items:

- Vandal X Dome Camera
- Drill & 5-1/2" Hole Saw

1. PREPARE MOUNTING SURFACE

The Vandal X Recess Mount requires a minimum 1-5/8" depth and can be installed into mounting surfaces up to 1-1/4" thick. Verify that the intended mounting surface meets these requirements before proceeding with the installation.

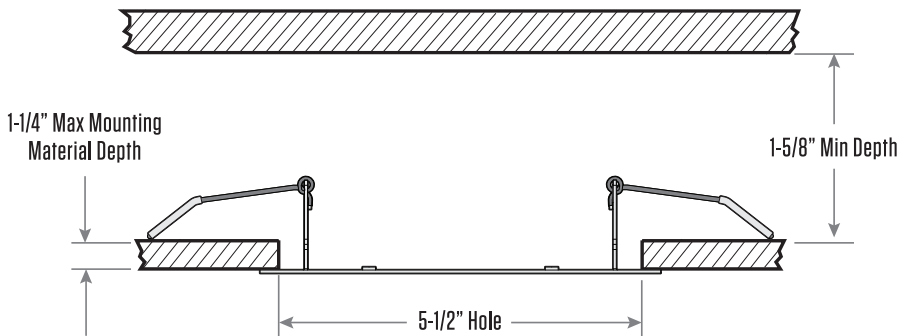

2. CUT HOLE

Cut a hole into the mounting surface with a 5-1/2" hole saw.

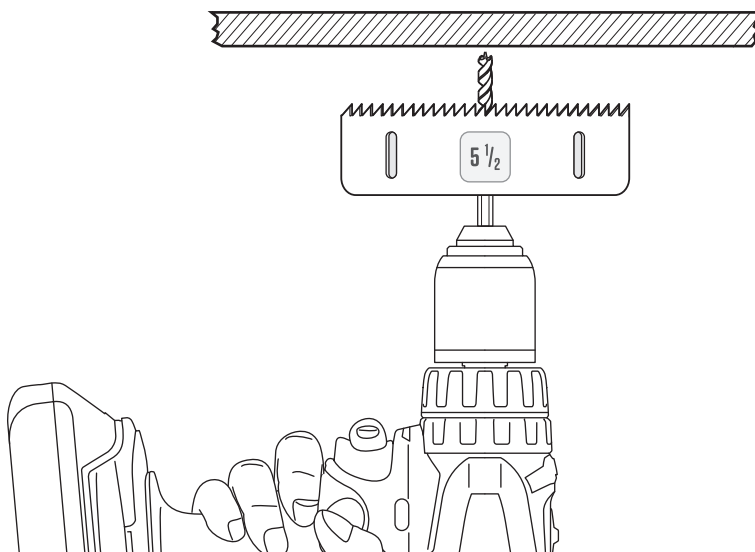

3. INSERT RECESS MOUNT

(A) Pull one of the spring mounts upwards slightly, (B) then guide the spring into the hole. (C) Pull the other spring mount into the hole and (D) guide the Recess Mount into the hole.

A.

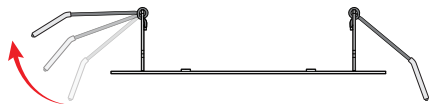

B.

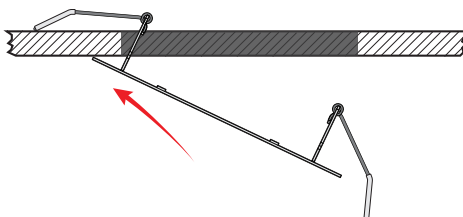

C.

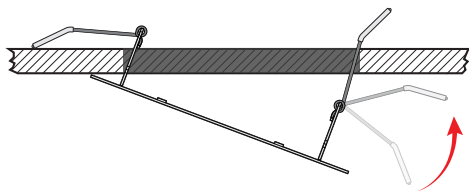

D.



4. INSTALL VX CAMERA

Disassemble the Vandal X camera as detailed in the install guide for that camera. Feed the power and video cables through the hole in the surface and Recess Mount and make connections. Align the tab on the camera with the slot in the Recess Mount when reassembling. Install the 4 screws (included with camera) to attach the camera assembly to the Recess Mount. The 4 holes are marked with arrowheads.

SLOT

TAB

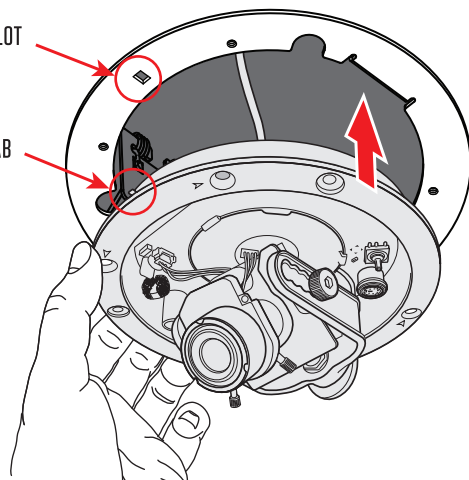

ARROWHEAD

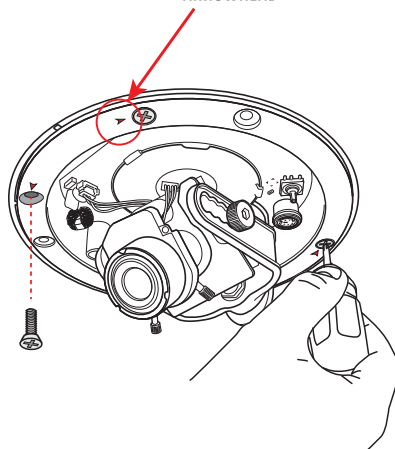

Make any required adjustments to the camera, then install the dome top as detailed in the install guide for the camera.