

CE-CTMP-6 Install Guide

Included Items:

- Ceiling Tile Mounting Plate Assembly
- Phillips Self Drilling Screws x 4

Required Items:

- 1" Hole Saw Drill Bit with Power Drill
- Phillips Head Screwdriver or Bit

Optional Items:

- Hole Saw Drill Bit for cable
- Pencil



ATTENTION!

USE ONLY AS DESIGNED

This fixture is designed to mount a camera 5-5/8" in diameter or smaller to a ceiling tile surface. The load bearing capability of ceiling tiles vary according to their overall size and thickness. Consult the ceiling tile manufacturer's specification for the maximum load capacity. Use with products heavier than the maximum weights indicated may result in instability causing possible injury.

1. CUT HOLE

The end of the flange bolt is designed with four cutting tips that allow you to cut a hole in the ceiling tile without the need for additional tools. To cut the hole, press the tip of the flange bolt firmly into the ceiling tile and rotate it clockwise until it cuts through. Alternatively, a 1" hole saw may be used to create the opening.

Flange Bolt Hole

Drilled Hole

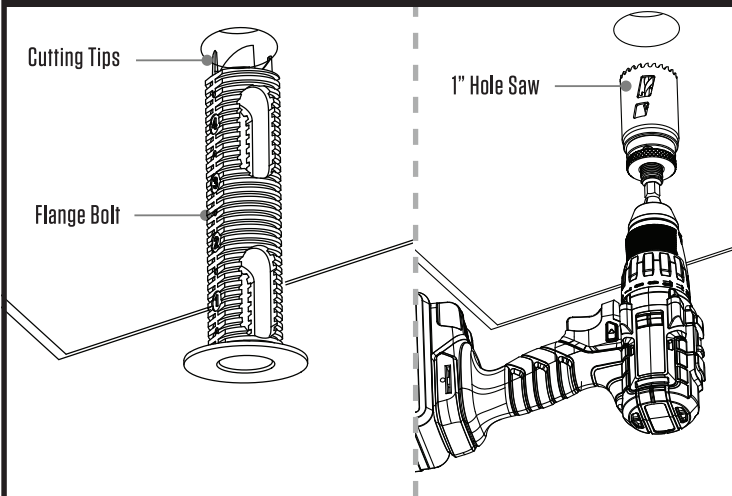

OPTIONAL:

After cutting the hole, the cutting tips on the flange bolt can be removed with pliers. Doing so helps reduce the risk of cable damage during installation.

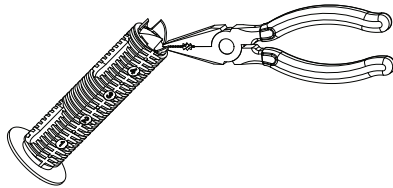

2. INSERT INTO CEILING TILE

Insert the flange bolt assembly into the hole created in Step 1. Then thread the locking nut onto the flange bolt until it fits securely and firmly grips the ceiling tile.

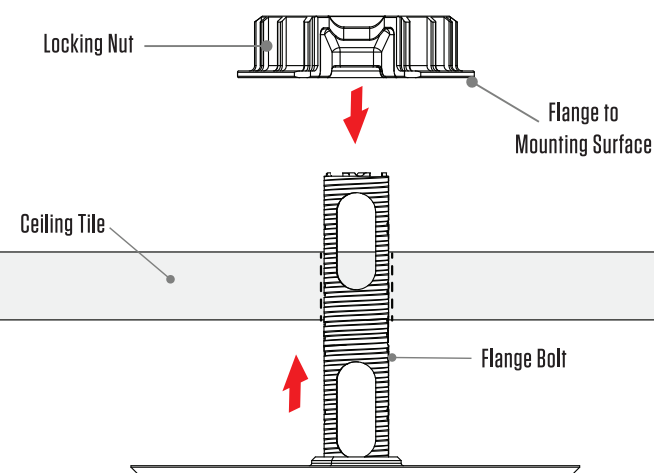

3. ATTACH CAMERA

For cameras with a center cable whip:

Feed the cable through the hollow flange bolt, then secure the camera to the mounting plate using the included Phillips self-drilling screws.

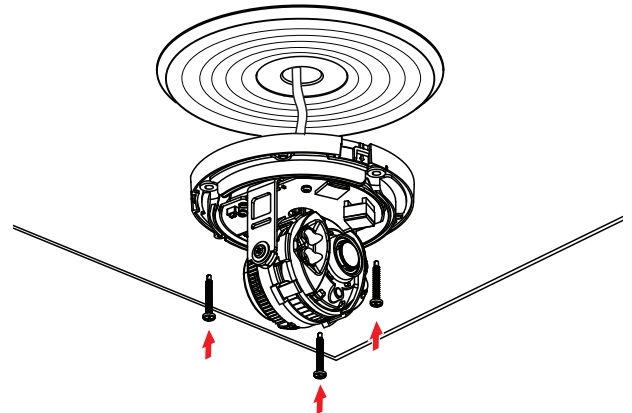

For cameras with side-exit cable ports:

Temporarily position the camera and mark the location of the cable exit. Using a hole saw, drill an opening large enough for the cable to pass through.

Note: Do not use standard drill bits, as they may catch on the mounting plate and cause damage or injury.

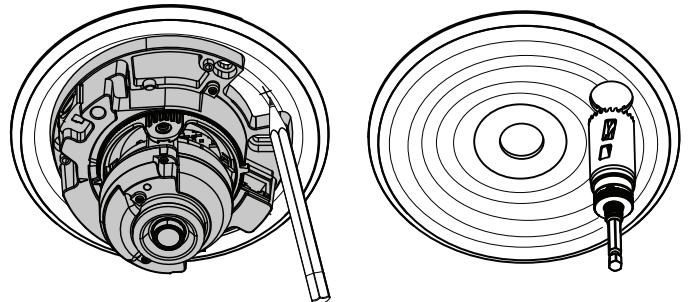

Note: When drilling an offset hole through the mounting plate, be sure to avoid the three flanges on the locking nut. If necessary, rotate the nut or adjust the drilling location to prevent interference with these flanges.

